

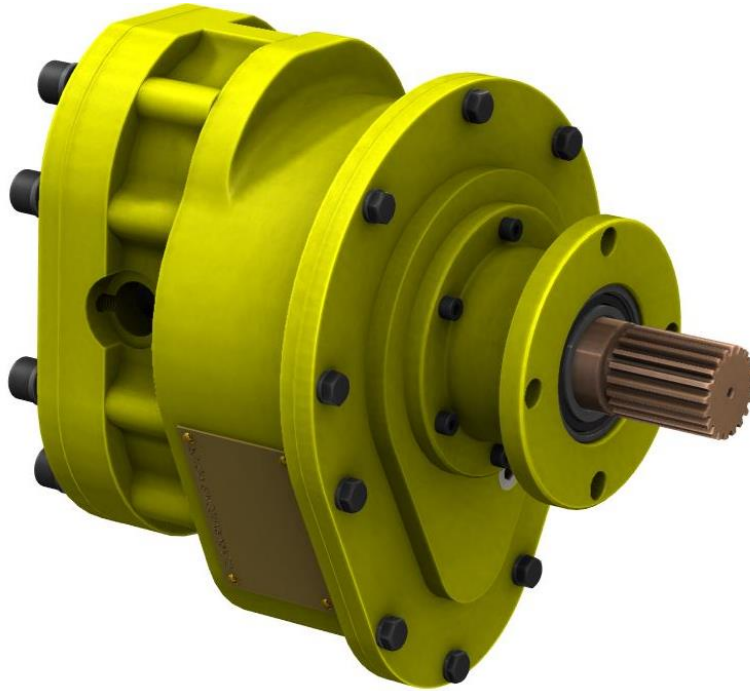

46AM61 SPARROW HAWK AIR MOTOR

PRODUCT DATA SHEET



46AM61... SPARROW HAWK AIR MOTOR

The Sparrow Hawk air motor is based on the RM102 that was designed by Clarks Mining Services almost 20 years ago. The RM102 has been used in both mining and construction as mixer motors, drill motors, air track tramming motors and power pack drives. The Sparrow Hawk air motor features the same robust RM102 gear rotors that are long lasting, have good wear characteristics and are also less susceptible to unfiltered air than other motors, such as vane and piston motors. The Sparrow Hawk air motor features robust construction, and has generous starting torque that is characteristic of a gear motor. The motor can be used to drive winches, hydraulic pumps, conveyors and fans. The Sparrow Hawk air motor is a good alternative to electric motors as it is suitable for use in hazardous zones. Optional IEC or SAE mounts are available with a variety of shafts to suit, and a choice of three gear ratios.

APPLICATION

- Civil
- Mining
- Pump drives
- Hazardous zones
- Conveyor drives
- Winch drives

OPTIONS

- IEC mount
- SAE mount
- DIN output shaft
- IEC output shaft

FEATURES

- Robust gear motor
- Gear reduction gearbox
- 3 gear ratios available
- Oil filled gearbox
- Fully reversible

Ph: +612 4272 8311
Fx: +612 4272 8533
30 Waverley Drive
Unanderra NSW 2526
sales@clarksmineingservices.com.au

Designers and manufacturers of
mining and construction equipment





46AM61 SPARROW HAWK AIR MOTOR

PRODUCT DATA SHEET

RATIO	6:1	9.72:1	13.875:1
POWER (@6 bar)	3.65 kW	3.65 kW	3.65 kW
STARTING TORQUE (@6 bar)	142 Nm	230 Nm	328 Nm
MAXIMUM FREE SPEED	1500 RPM	925 RPM	650 RPM
AIR CONSUMPTION	273 SCFM at peak power at 6 bar		
ACOUSTIC LEVEL	101 dB(A) with muffler, 120dB(A) no muffler		
WEIGHT	SAE Mount -28kg SAE Mount - 30kg		
DIMENSIONS – SAE Mount	323mm x 272mm x 220		
DIMENSIONS – IEC Mount	308mm x 272mm x 220mm		
FILTRATION REQUIRED	40 micron		
REQUIRED AIR LUBRICATION	Rock Drill Oil ISO100-110 (variable)		
MAXIMUM AIR SUPPLY PRESSURE	6 bar		

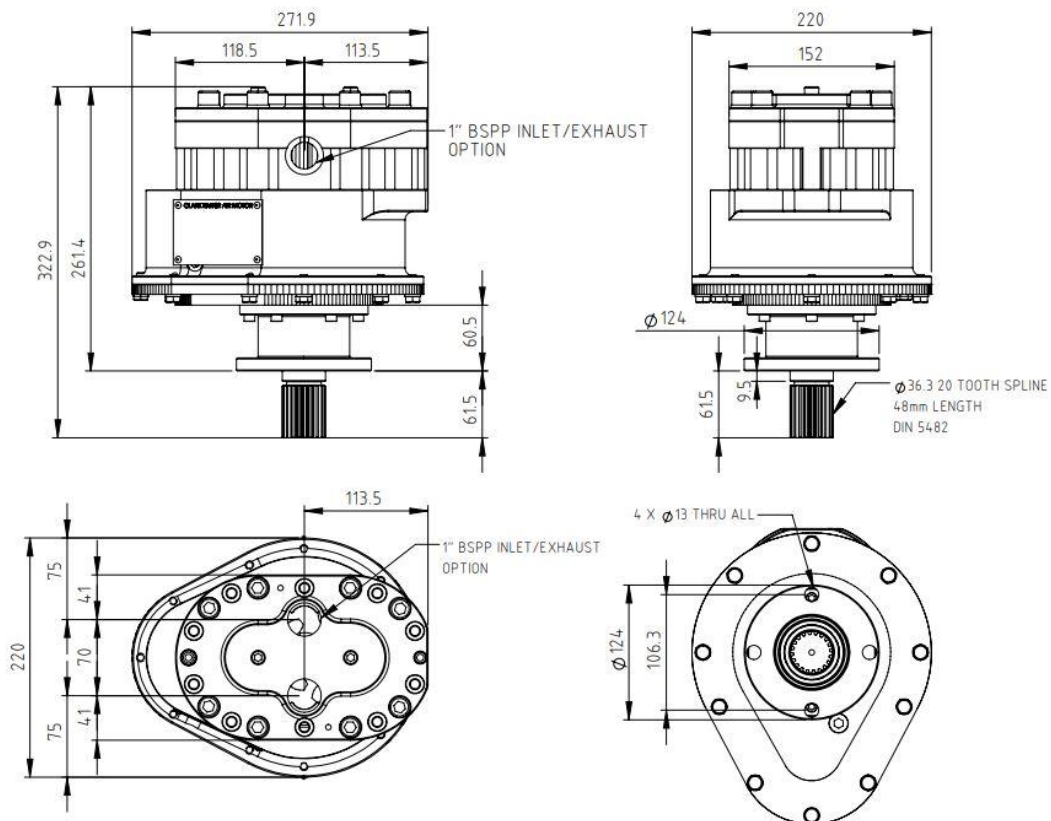

Figure 1 General Arrangement

Ph: +612 4272 8311
 Fx: +612 4272 8533
 30 Waverley Drive
 Unanderra NSW 2526
 sales@clarksmineingservices.com.au

Designers and manufacturers of
 mining and construction equipment





46AM61 SPARROW HAWK AIR MOTOR

PRODUCT DATA SHEET

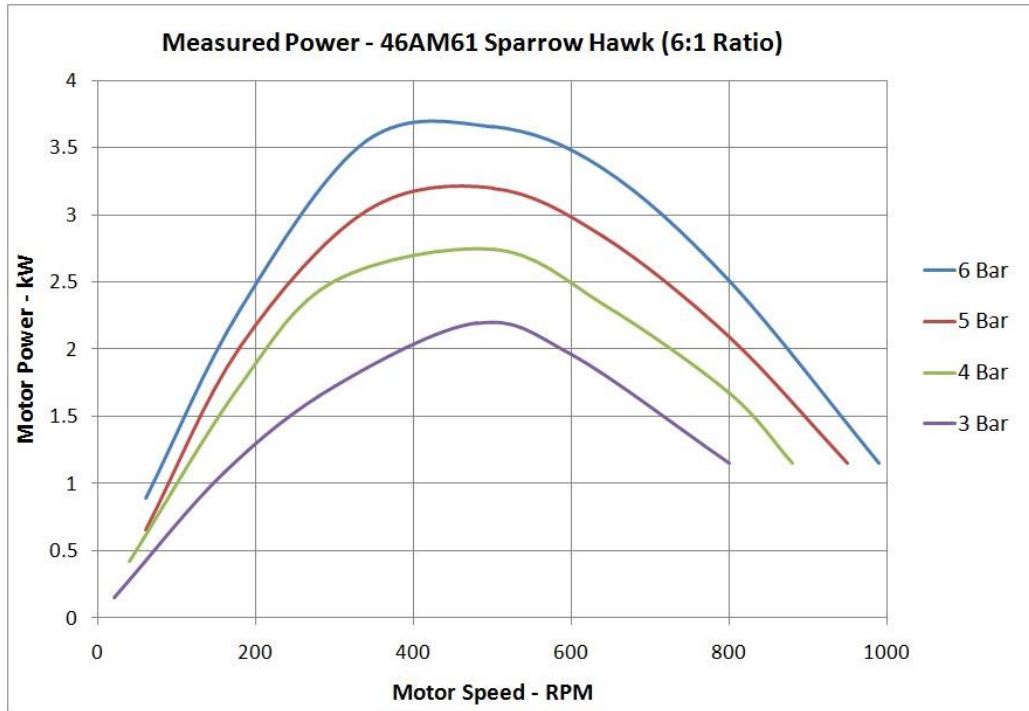

Ph: +612 4272 8311
Fx: +612 4272 8533
30 Waverley Drive
Unanderra NSW 2526
sales@clarksmineingservices.com.au

**Designers and manufacturers of
mining and construction equipment**





46AM61 SPARROW HAWK AIR MOTOR

PRODUCT DATA SHEET

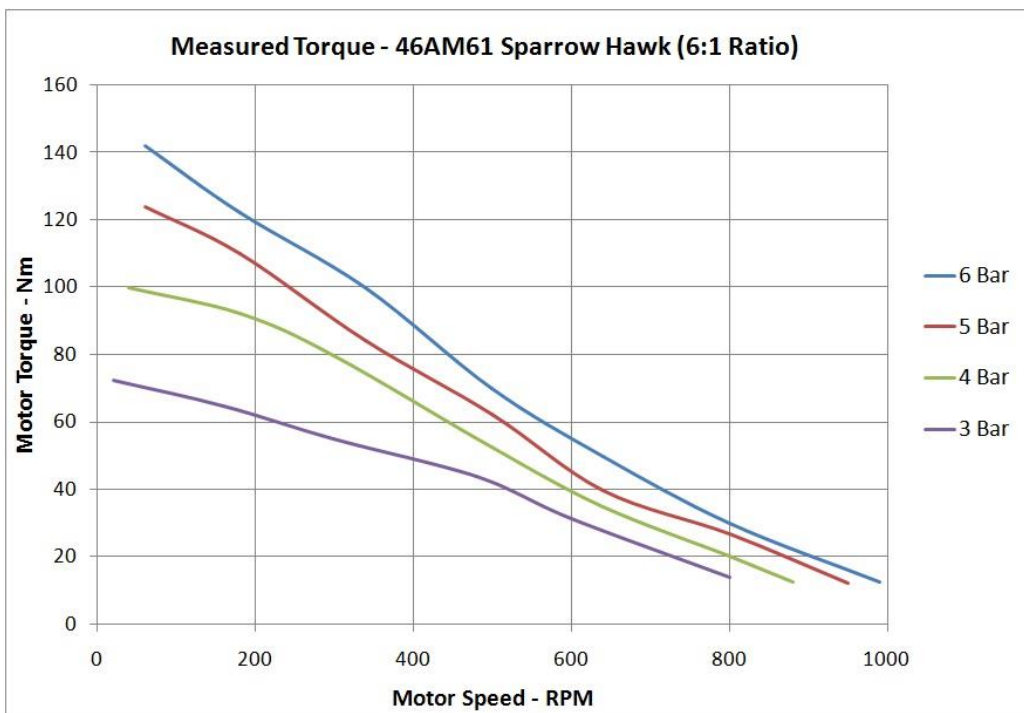
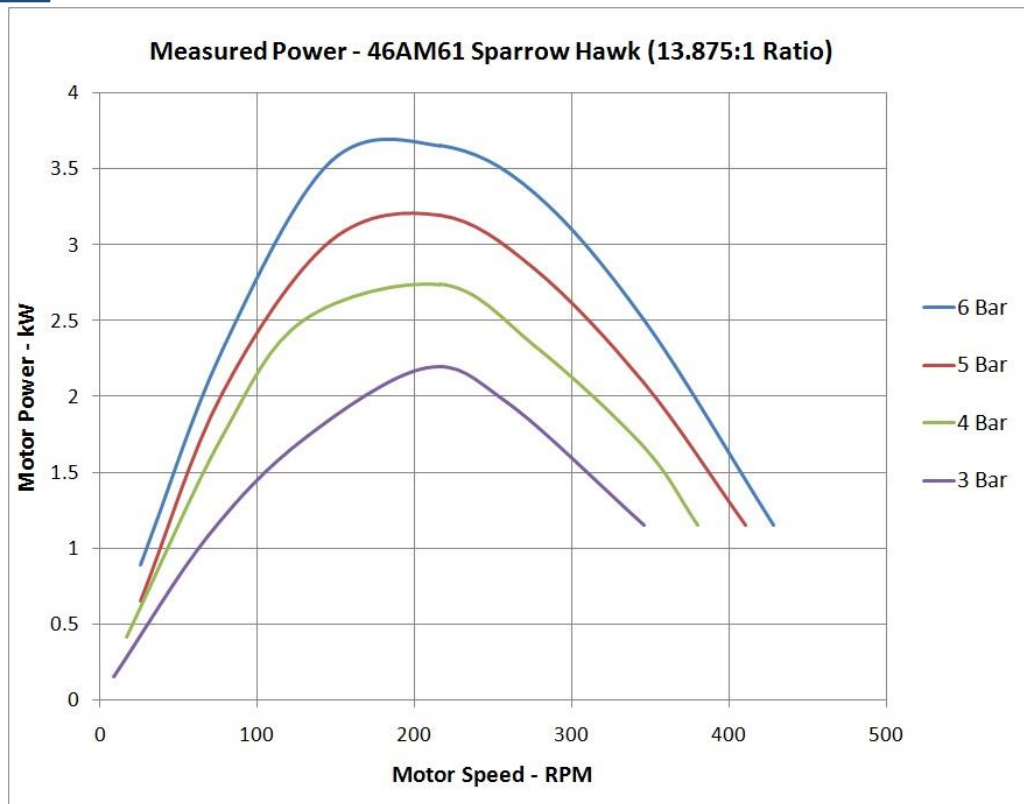

Ph: +612 4272 8311
Fx: +612 4272 8533
30 Waverley Drive
Unanderra NSW 2526
sales@clarksmineingservices.com.au

**Designers and manufacturers of
mining and construction equipment**





46AM61 SPARROW HAWK AIR MOTOR

PRODUCT DATA SHEET



Ph: +612 4272 8311
Fx: +612 4272 8533
30 Waverley Drive
Unanderra NSW 2526
sales@clarksmineingservices.com.au

**Designers and manufacturers of
mining and construction equipment**





46AM61 SPARROW HAWK AIR MOTOR

PRODUCT DATA SHEET

Measured Air Consumption - 46AM61 Sparrow Hawk

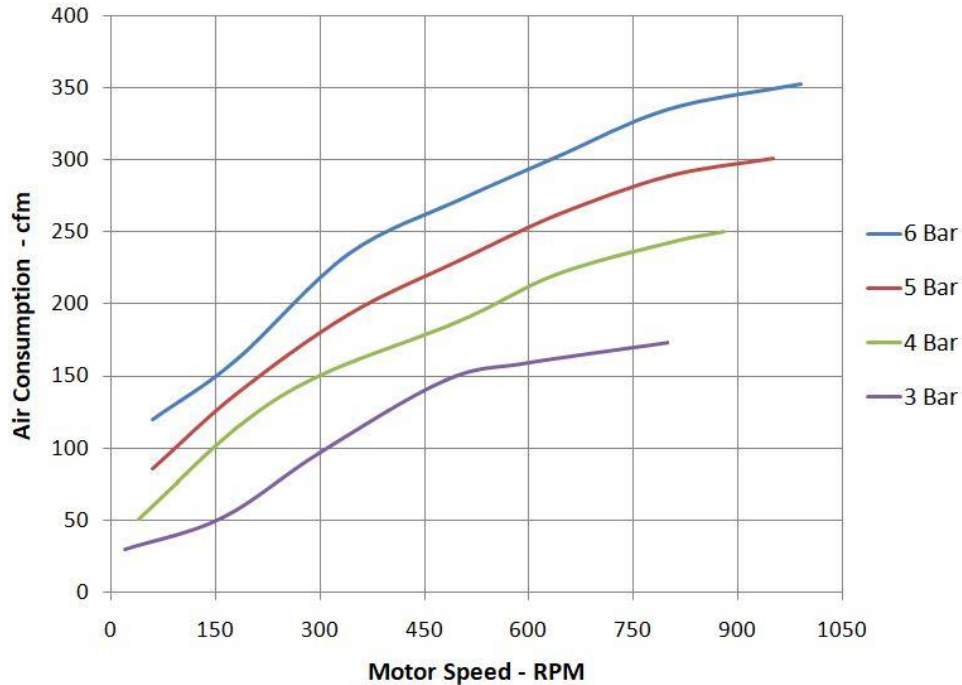

OPTION SELECTOR

Sample Model No	4	6	A	M	6	1	1	5	3	0	1
Position	0	1	2	3	4	5	6	7	8	9	10
0 1	46 = Category										
2 3	AM = Descriptor (Air Motor)										
4 5	61 = Sparrow Hawk Motor										
6	1 = Level										
7	1 = IEC 100 B14 Mount 5 = SAE A Mount										
8	1 = 28mm Diameter shaft, 8mm key 3 = DIN 5482 20 tooth shaft										
9 10	01 = Side Port (open) 02 = End Port (open)										

Ph: +612 4272 8311
 Fx: +612 4272 8533
 30 Waverley Drive
 Unanderra NSW 2526
 sales@clarksmineingservices.com.au

Designers and manufacturers of
 mining and construction equipment

