



CLARK HRP HYDRAULIC DRIFTER

Product Data Sheet



HRP DRIFTER

The HRP range of rotary percussive drifter is ideal for drilling soft to hard rock. The rig mounted drifter is fitted with a male R32 shank and is ideal for drilling from Ø45 to Ø71mm to a maximum depth of 9 metres. The drifter can be fitted almost any style of feed mast and has been used successfully on the Clark AT5000HL drill rig.

Applications:

- Roof bolting
- Rib drilling
- Spiling
- Coring
- Floor drilling

Options:

- R25 shank
- R32 shank
- H25 shank

Features:

- Metal construction
- Water flushing
- Variable speed



*Designers and
manufacturers of
mining and construction
equipment*

A.B.N. 42 050 287 173 | A.C.N. 050 287 173

SALES

ph. 612 4272 8311
fx. 612 4272 8533
30 Waverley Drive
Unanderra NSW 2526
cmsadmin@bigpond.com

ACCOUNTS

ph. 612 4271 4036
fx. 612 4271 4015
30 Waverley Drive
Unanderra NSW 2526
clarksmineaccounts@bigpond.com

www.clarksmineingservices.com.au

[▶ goo.gl/qOoy4K](https://www.youtube.com/watch?v=qOoy4K)



CLARK HRP HYDRAULIC DRIFTER

Product Data Sheet

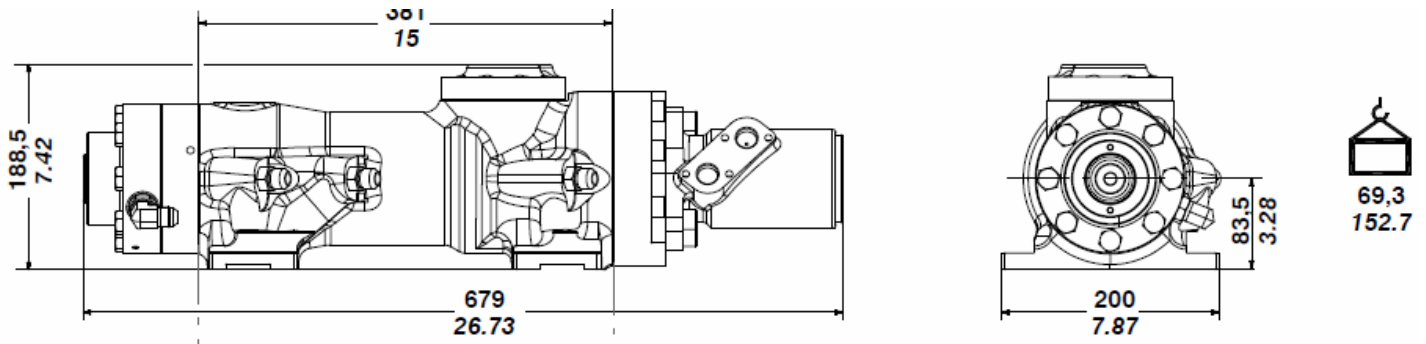

Drifter performance:

Strike flow l/mn	45
Strike pressure maxi bar	140
Strike frequency maxi Hz	50
Energy per blow J	90
Rotation motor	M100
Rotation flow maxi l/mn	30
Rotation pressure maxi bar	140
Max rotation torque Nm	200
Rotation speed setting t/mn RPM	150-300
Water flushing pressure bar	15
Water flushing flow l/mn	30
Air flushing pressure bar	4-Oct
Front guide lubrication pressure bar	0.5
Front guide lubrication air flow l/mn	200
Rod type	R32



*Designers and
manufacturers of
mining and construction
equipment*

A.B.N. 42 050 287 173 | A.C.N. 050 287 173

SALES

ph. 612 4272 8311
fx. 612 4272 8533
30 Waverley Drive
Unanderra NSW 2526
cmsadmin@bigpond.com

ACCOUNTS

ph. 612 4271 4036
fx. 612 4271 4015
30 Waverley Drive
Unanderra NSW 2526
clarksmineaccounts@bigpond.com