

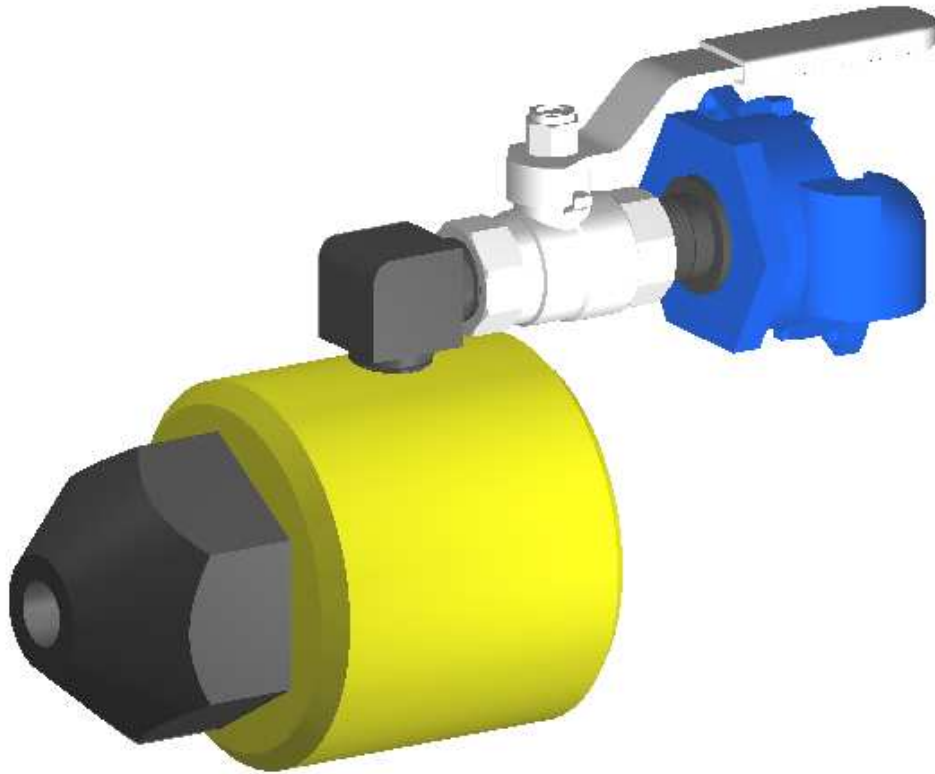

# CLARK GROUT & MORTAR SPRAY GUN

Product Data Sheet



## Grout & Mortar Spray Gun

The Clark grout and mortar spray gun is an air assisted applicator for applying cement or plaster based material to a pre-determined thickness in mining and construction applications. The main body is manufactured from light weight impact resistant cast nylon. The spray gun is available as a stand alone unit or with a wand for reaching various heights. The spray gun is ideal for use with pumps from the Clark grout range.

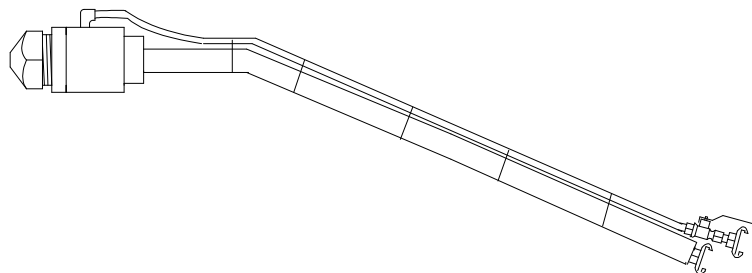

### Applications:

- Ground stabilization
- Ventilation control
- Concrete repairs
- Waterproofing

### Features:

- Choice of wand length
- Dust free operation
- Wear resistant nozzle
- Very low rebound

### Suitable fluids:

- Plaster compounds
- Water proofing material
- Cement renders
- Fiber based material



*Designers and  
manufacturers of  
mining and construction  
equipment*

A.B.N. 42 050 287 173 | A.C.N. 050 287 173

#### SALES

ph. 612 4272 8311  
fx. 612 4272 8533  
30 Waverley Drive  
Unanderra NSW 2526  
cmsadmin@bigpond.com

#### ACCOUNTS

ph. 612 4271 4036  
fx. 612 4271 4015  
30 Waverley Drive  
Unanderra NSW 2526  
clarksmineaccounts@bigpond.com

[www.clarksmine.com.au](http://www.clarksmine.com.au)

[goo.gl/q0oy4K](https://www.youtube.com/watch?v=q0oy4K)