

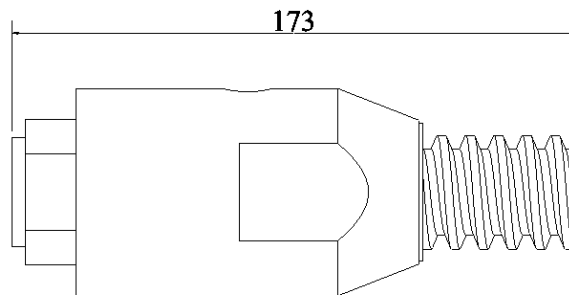

CLARK WATER SWIVEL AW

Product Data Sheet

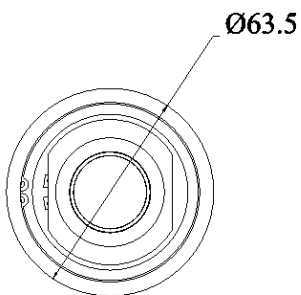

Specifications

- Stainless steel construction
- Suits AW drill rod
- $\frac{3}{4}$ "BSP inlet
- Weight 1.9kg
- Flats for spanner – 56mm
- Double ball bearing
- Grease nipple for bearings
- Single water internal water seal
- Compact design
- Parts sold individually or as an assembly
- Use with Clark drill rigs



*Designers and
manufacturers of
mining and construction
equipment*

A.B.N. 42 050 287 173 | A.C.N. 050 287 173

SALES

ph. 612 4272 8311
fx. 612 4272 8533
30 Waverley Drive
Unanderra NSW 2526
cmsadmin@bigpond.com

ACCOUNTS

ph. 612 4271 4036
fx. 612 4271 4015
30 Waverley Drive
Unanderra NSW 2526
clarksmineaccounts@bigpond.com

www.clarksmineaccounts.com.au

[▶ goo.gl/q0oy4K](https://www.youtube.com/watch?v=q0oy4K)